

FREEHOLD



House - End Terrace (EPC Rating: C)

HEATHWAY, DAGENHAM, RM9 6AY

Guide Price

£425,000



3 Bedroom House - End Terrace located in Dagenham

FABULOUS EXTENDED HOUSE....CLOSE TO HEATHWAY STATION. Huge kitchen diner TWO BATHROOMS, parking for THREE CARS, outbuilding. Two reception rooms. Guide Price £425,000-£450,000 NO CHAIN

LARGE HALLWAY

FRONT RECEPTION

11 x 10

Window to front.

REAR RECEPTION

15'9 x 10'9

Open to....

EXTENDED KITCHEN DINER

19 x 11

Velux roof windows, doors to garden.

DOWNSTAIRS SHOWER ROOM

10 x 6

Three piece suite /WC

LANDING

Loft access with combi boiler, side window.

BEDROOM ONE

15 x 10

Window to front.

BEDROOM TWO

11 x 10

Window to rear.

BEDROOM THREE

9'6 x 7'6

Window to front.

UPSTAIRS BATHROOM

Three piece suite, window

EXTERIOR

Good size paved front drive, off road parking for THREE CARS, side access to...

back garden with decking area and large 28 x 13 outbuilding with electric.

We routinely refer potential purchasers to Move with Us Ltd. It is your decision whether you choose to deal with Move with Us Ltd. In making that decision, you should know that we receive an annual payment benefits from Move with Us Ltd, equating to approximately £314.48 per referral.



Ground Floor

Approx. 61.2 sq. metres (658.4 sq. feet)

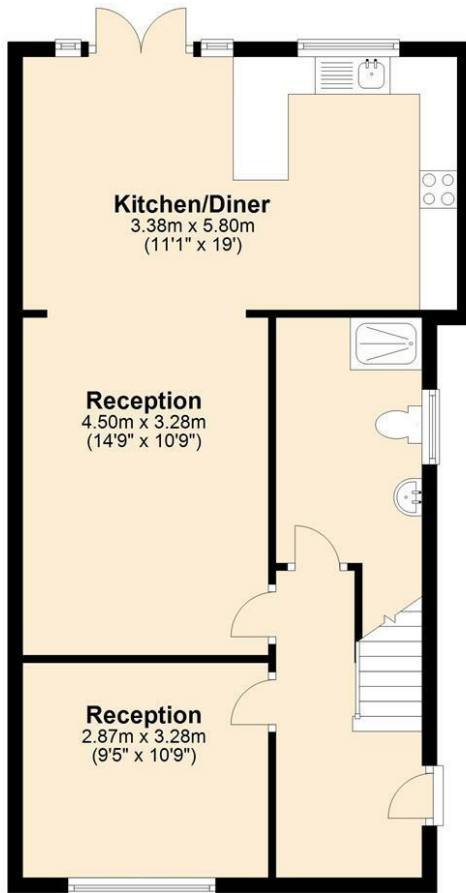

First Floor

Approx. 39.7 sq. metres (427.0 sq. feet)

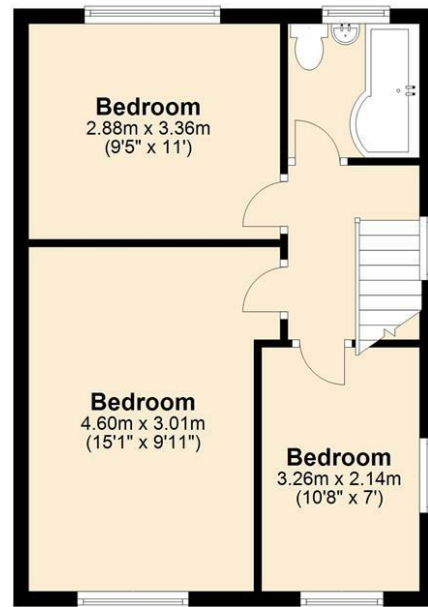

Total area: approx. 100.8 sq. metres (1085.4 sq. feet)

Council Tax Band

C

Energy Performance Graph

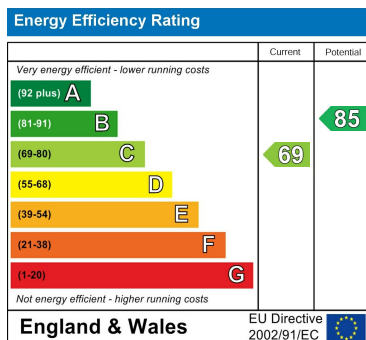

Call us on

020 8593 5933

dagenham@steps.me.uk

www.steps.me.uk

Agents Note: Whilst every care has been taken to prepare these particulars, they are for guidance purposes only. All measurements are approximate and are for general guidance purposes only and whilst every care has been taken to ensure their accuracy, they should not be relied upon and potential buyers are advised to recheck the measurements.

STEPS

Estate Agents